

钛

内六角盖帽螺钉 ISO 4762 / JIS B1176 / DIN 912

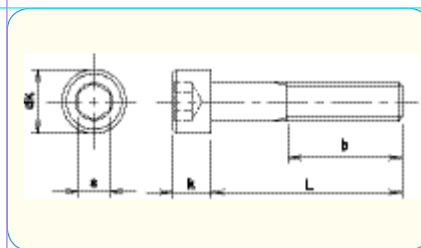

●材料
钛



	M3	M4	M5	M6	M8	M10	M12
dk	5.5	7	8.5	10	13	16	18
k	3	4	5	6	8	10	12
s	2.5	3	4	5	6	8	10



		件/箱					
L \ d	M3	M4	M5	M6	M8	M10	M12
6	200	200					
8	200	200	100	100			
10	200	200	100	100			
12	200	200	100	100			
15	200	200	100	100	100	50	
16	200	200	100	100	100	50	
20	200	200	100	100	100	50	
25	* 200	200	100	100	100	50	30
30		* 200	* 100	100	100	50	30
35		* 200	* 100	* 100	100	50	30
40		* 200	* 100	* 100	* 100	50	30
45			* 100	* 100	* 100	* 50	30
50			* 100	* 100	* 100	* 50	30
55			* 100	* 100	* 100	* 50	* 30
60			* 100	* 100	* 100	* 50	* 30

* ... 半螺纹

钛：纯净的钛 JIS H4670 TW270 or TW340.

内六角盖帽螺钉 ISO 4762 / JIS B1176 / DIN 912

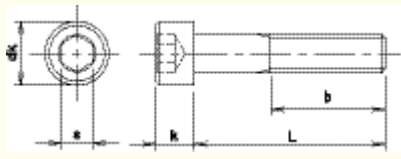

- 材料
钛 合金钛 (6-4Ti)
- 没有滚花



遵从 RoHS 指示

	M5	M6	M8
dk	8.5	10	13
k	5	6	8
s	4	5	6
b	22	24	28

件 / 箱

L \ d	M5	M6	M8
5	100		
6	100		
8	100		
10	100	100	
12	100	100	
16	100	100	100
20	100	100	100
25	100	100	100
30	100	100	100
35	100	100	100
40	100	100	100
45		100	100
50		100	100
55		100	100
60		100	100

内六角凹端固定螺钉 ISO 4029 / JIS B1177 / DIN 916

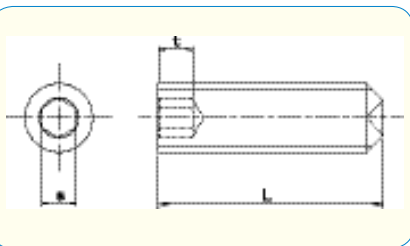

- 材料
钛



	M4	M5	M6	M8
s	2	2.5	3	4
t	2.5	3	3.5	5

件 / 箱

L \ d	M4	M5	M6	M8
6	200	150	150	
8	200	150	150	100
10	20	150	150	100
12	200	150	150	100
15	200	150	150	100
20			150	100



遵从 RoHS 指示

钛：纯净的钛 JIS H4670 TW270 or TW340.